

2-1

2-3

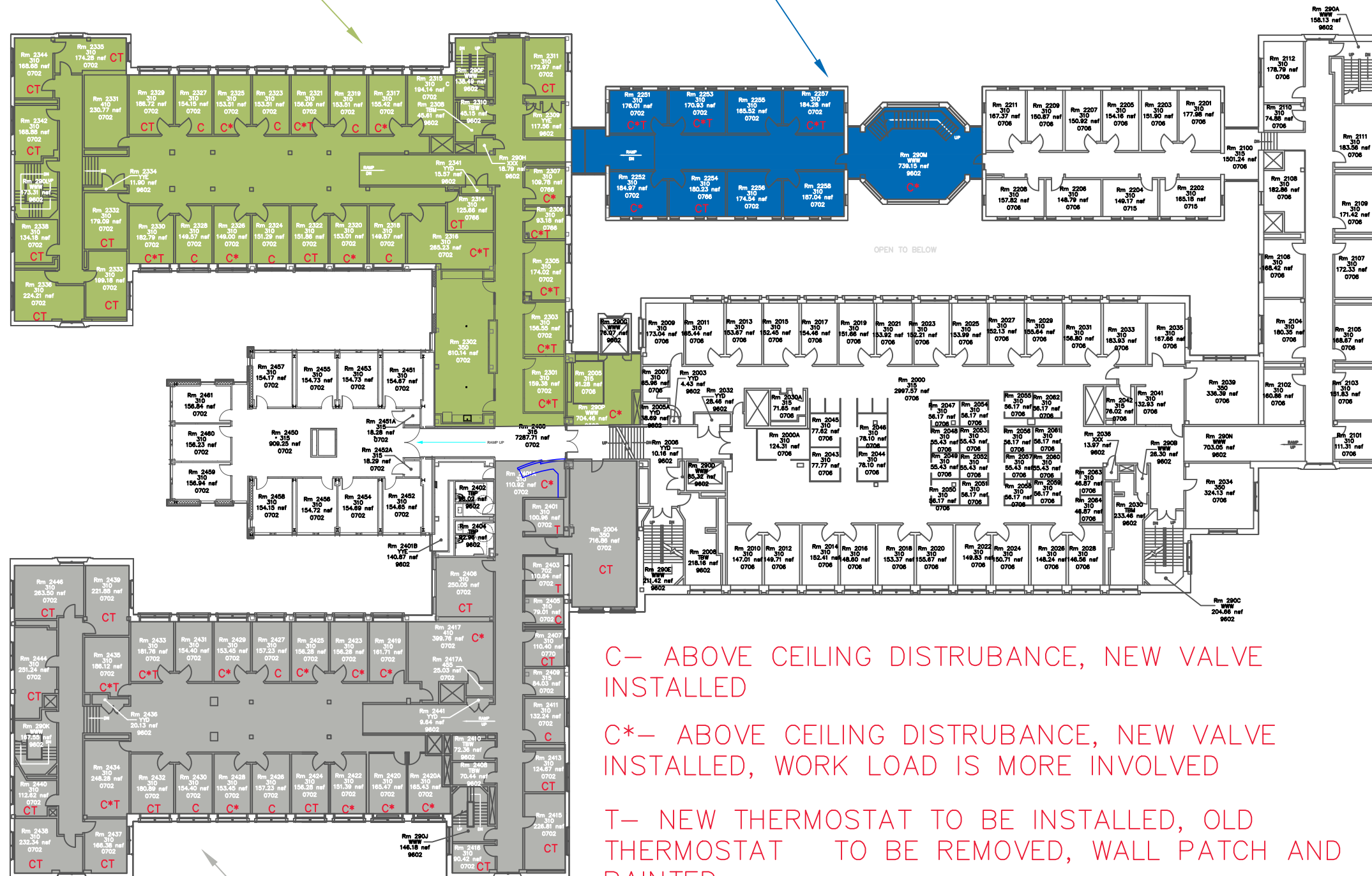

C- ABOVE CEILING DISTURBANCE, NEW VALVE INSTALLED

C\*- ABOVE CEILING DISTURBANCE, NEW VALVE INSTALLED, WORK LOAD IS MORE INVOLVED

T- NEW THERMOSTAT TO BE INSTALLED, OLD THERMOSTAT TO BE REMOVED, WALL PATCH AND PAINTED

Building: Steinberg Hall - Dietrich Hall  
 Floor: Floor 2  
 Usable: 37980.75 SF  
 Common Area: 4836.73 SF  
 Walls/Shafts/Core VP: 7308.94 SF  
 Floor Gross: 50126.42 SF  
 Construction Gross: 54871.34 SF

2-2