

# 3-2

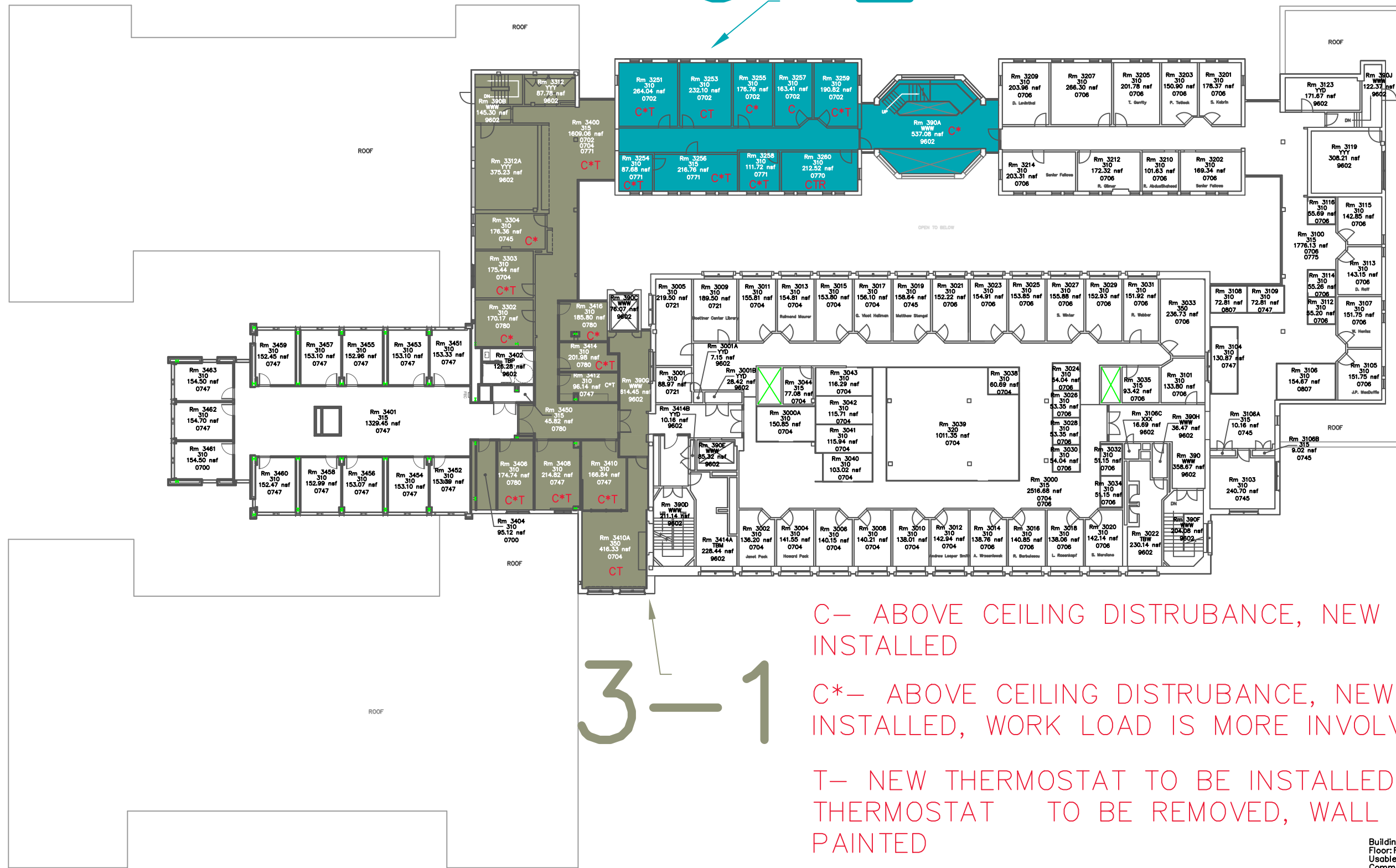

C- ABOVE CEILING DISTURBANCE, NEW VALVE INSTALLED

C\*- ABOVE CEILING DISTURBANCE, NEW VALVE INSTALLED, WORK LOAD IS MORE INVOLVED

T- NEW THERMOSTAT TO BE INSTALLED, OLD THERMOSTAT TO BE REMOVED, WALL PATCH AND PAINTED

Building: Steinberg Hall - Dietrich Hall  
 Floor: Floor 3  
 Usable: 22140.38 SF  
 Common Area: 3963.74 SF  
 Walls/Shfts/Core VP: 8333.61 SF  
 Floor Gross: 34435.74 SF  
 Construction Gross: 34435.74 SF